

No 95
Winter 2021 Vol. 32

Traffic Light REPORT

Magazine for traffic engineering



OUR FAVORITE

CHRISTMAS LIGHTS





Dear readers,

I started at RTB on September 1 in International Sales. My first impressions have been very positive. That's because at RTB, anything is possible. Personal commitment and imagination are supported in every way.

At my previous employer in the automotive industry, it was all about standardized procedures and processes. Those are important too, but they put a damper on creativity. RTB combines the best of both worlds for me.

My focus is the acquisition and support of international customers for our entire product portfolio. The emphasis here is certainly on the equipping of traffic light systems and the market-leading system LOC.id. But even more, focusing on the customer is top priority. That is also why our conversations with users are so important to us.

Interacting with the German Federation of the Blind and Partially Sighted (DBSV) at the ITS World Congress offered me a completely different perspective. Our focus is clear: All road users, and more specifically, also people with special needs, should be able to safely move through traffic.

Sincerely,

Silke Meelker

International Sales

CONTENTS & EDITORIAL 2

INNOVATIONS NEED SPACE 3

ITS WORLD CONGRESS:
AN AMAZING PREMIERE 4-5

ITS WORLD CONGRESS:
A DIALOG WITH DBSV 6-7

UPDATE ON THE RADAR PUSH BUTTON 8

CASHLESS TICKET MACHINES 9

TALKING CONSTRUCTION SITES 10

TOPO.APP AND LIVE DATA 11

ODDS & ENDS 12

NEW DEVELOPMENT CENTER AT KAMEN SITE

INNOVATIONS NEED SPACE

RTB has been at its site in Kamen since 2004. Ever since, the company's central development team has grown - a result of a wealth of well-educated and trained technical specialists. Now RTB is taking the next step in Kamen. In a place where people once toiled away and the earth was brimming with energy, RTB will start off 2022 with the construction of a new development center.

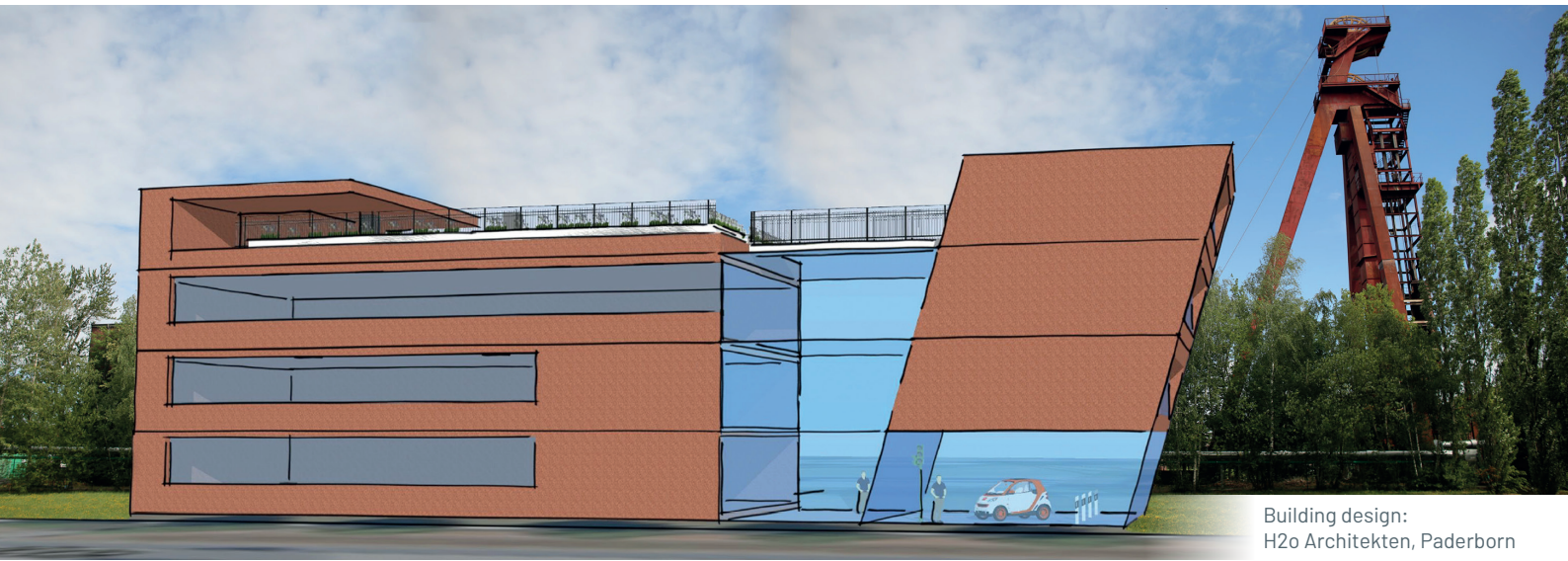

Building design:
H2o Architekten, Paderborn

Further expansion of RTB's development team is a direct result of the world's overall economic situation. As the trend toward digitalization marches on, so does the market's desire for innovation. This trend plays into the hands of companies with creative ideas and their own products, if they have the resources to try new approaches and manage customer requirements.

RTB has acquired a plot of land right next to the winding tower in the Kamen Technology Park - a location that offers many possibilities. A building with a showroom and training facilities, representative of the economic upswing in Germany, will be constructed in one of Europe's largest metropolitan areas. Over the course of the new construction, RTB will at least double the number of developers from currently more than 20.



ITS WORLD CONGRESS:

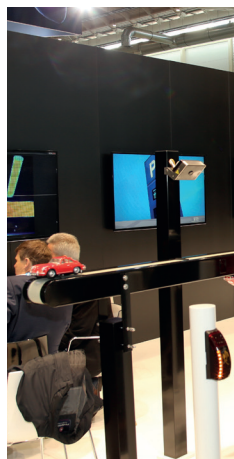
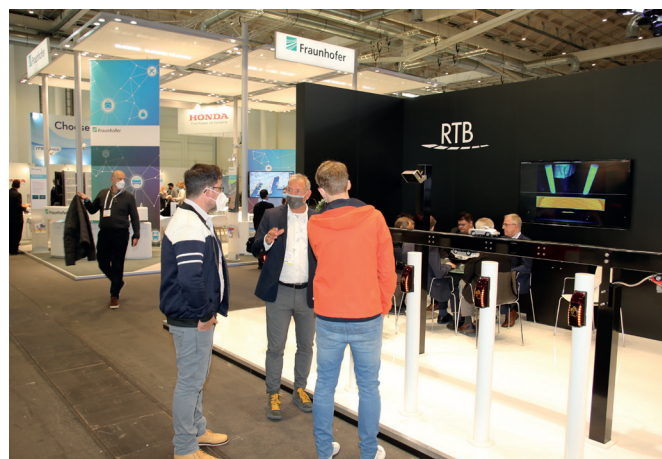

AN AMAZING PREMIERE

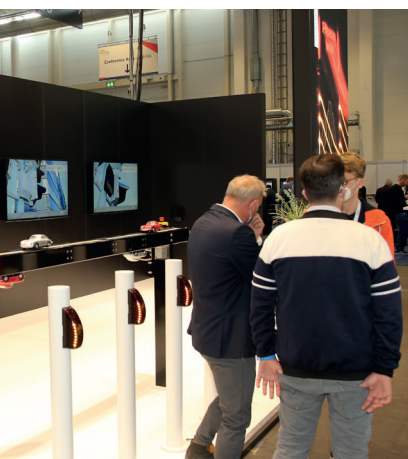

Just before the start signal, there was a feeling of heightened expectation. But today there is no question that the ITS World Congress in Hamburg, held for the first time in Germany, was a major success. More than 13,000 technology enthusiasts came to learn about the future of mobility.

It was without a doubt worthwhile for RTB to participate in this international exhibition with a large-scale booth. Not just the official number of visitors, but above all, the many high-profile contacts who visited the RTB booth demonstrated the extreme interest in modern solutions by municipalities, companies, and partners.

With the cancellation of Intertraffic in Amsterdam due to the coronavirus, the ITS World Congress was the first international meeting place for international transport technology in four years. The thirst for information about new products was great, because the interplay between transport and the environment is a key issue and holds many requirements in many countries.

The exhibition area was dominated by three topics that RTB had presented in the recent years. Many are interested in switching to the non-contact radar scanner on traffic light systems and are thinking about purchasing cashless parking ticket machines. They also want to optimize their real-time traffic data acquisition with the TOPO product family.

Hamburg has once again shown that international industry events are indispensable for promoting exchange and generating new product ideas.



ITS WORLD CONGRESS:

LOC*id*



Dr. Thomas Krämer teaches RTB employees



From left to right: Dr. Thomas Krämer, Klaus Hahn, Franz Schober (YUNEX), Andreas Hegemann (RTB Elektronik), Gerhard Renzel (from back to front)



From left to right: Dr. Thomas Krämer, Klaus Hahn, Gerhard Renzel, Peter Brill (Managing Director of the Federal Association for Rehabilitation Instructors for the Blind and Partially Sighted)



From left to right: Andreas Roller (INIT), Manfred Retka (Trapeze), Jana Mattert, Dr. Thomas Krämer

NETWORK MEMBERS



SUPPORTERS



A DIALOG WITH DBSV

It had never happened before: for the first time ever, a support group presented itself at an international congress for road traffic technology. The German Federation of the Blind and Partially Sighted (DBSV) was actively involved in the exhibition at its own booth and had a lot to say about pressing issues.

The best indicator of the success of an exhibition booth is always its visitors. And here things went exceptionally well for the DBSV. Numerous representatives of large-scale industry and leading companies in the field of mobility learned about the concerns and wishes of blind and partially sighted to integrate these aspects into their product development.

The focus of discussions was the LOC.id system, which facilitated guidance for the blind via an app. From indoor and outdoor navigation to car-to-x connectivity. In particular, the noise emitted by electric vehicles was the focus of intensive exchanges with representatives from the business community.

President Klaus Hahn, Presidium Member, Dr. Thomas Krämer, Commissioner for Construction and Transport Gerhard Renzel and Accessibility Officer Jana Mattert were enthusiastic about the great response at the ITS World Congress. In a session entitled "Smart Mobility improves social participation of people with reduced mobility", Dr. Thomas Krämer, Manfred Retka and Andreas Roller discussed key topics. The session was moderated by Jana Mattert.

Our conclusion: all participants should continue the dialog and also include the experts of the European associations for the blind, who showed great interest in the discussions.

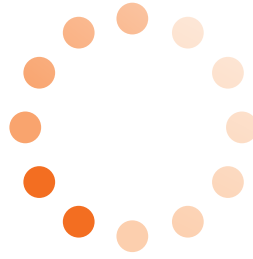

NEW UPDATE...

RADAR PUSH BUTTON



RTB's new radar button has caused quite a stir among experts. Due to its non-contact functionality, the new product for traffic light systems is a perfect fit for the times. With this innovation, RTB exemplifies how digitalization can be successfully integrated into product development.

Use "in the field" in particular, is a great indicator of which adjustments still need to be made. The constructive feedback from several pilot users has led to relevant improvements. RTB would like to thank all customers for their valuable observations and suggestions, which have resulted in adjustments and further developments to the software. Of course, all radar scanners already installed will also receive an update.

The central challenge can be described as follows: the push button should react as quickly as possible without impairment to its functionality by crossing pedestrians or by weather conditions (e.g., snowfall). The experience gained so far can help to achieve these goals - both for new installations and for the replacement of existing push buttons.



CASHLESS

TICKET MACHINE

Known as the cashless all-rounder, RTB's newest ticket machine, PICAVE, has quickly established itself in the market. Due to the great response, the company has quickly responded with the ability to design and retrofit even existing ticket machines to be cashless.

Coins are a thing of the past—users want to be able to buy their parking ticket or other tickets (e.g., for camper van parking spaces) as conveniently as possible and, above all, hygienically. When the most recent generation of ticket machines was introduced, many customers wanted to convert their existing machines to cashless operation. This option is now available.

PICAVE: Big advantages

- Maximum convenience via touch display
- Multiple areas of application
- Payment on arrival (Pay & Go)
- Payment on departure (Real-Time Parking)





“Talking Construction Sites”

In dialog with the German Association for the Blind and Partially Sighted (DBSV), a new field application already known to local authorities has emerged. With the many different types of construction sites, especially in large cities, challenges that seem insurmountable arise more frequently. The LOC.id system can offer “talking construction sites” and thus significantly improve the orientation of all parties involved.

Long-term construction sites, for example in the vicinity of train stations or other neuralgic traffic junctions, require pedestrians to pay close attention in order to recognize route changes. What already poses a challenge for sighted people often proves to be an insurmountable task for blind and partially sighted people. After all, numerous noises (e.g., jackhammers) also factor in.

In these specific situations, unambiguous speech signals are required to facilitate orientation for all those involved and to indicate the route to be taken. The LOC.id system has already proven its practical suitability in several comparable applications. Under the leadership of the DBSV, a working group consisting of many companies and traffic experts was founded.

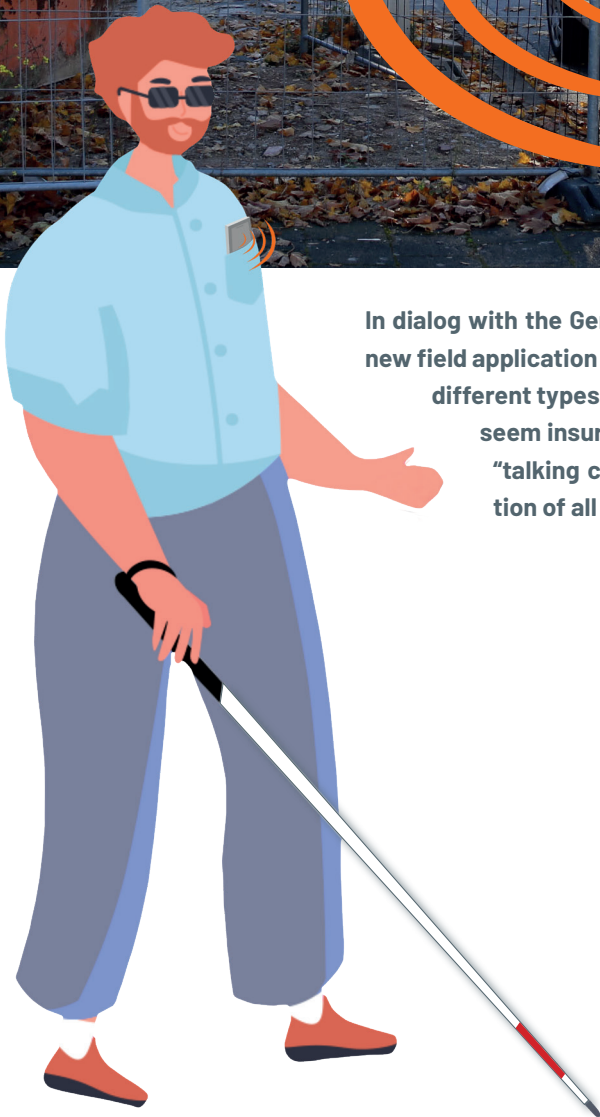

LOC id



TOPO.APP AND LIVE DATA

TOPO is the only radar-based system that performs axle detection along with length and speed measurement. Due to the exceptional detection accuracy according to 8+2 vehicle classes, the system is highly demanded in the market. Also at the suggestion of users, RTB now offers a TOPO.app and live data as well.

TOPO systems classify the vehicle at the exact moment the vehicle passes the detector. The system can thus provide valuable real-time data

that can be transferred directly to the traffic computers. This facilitates specific and precise responses to the traffic situation at hand.

All next generation TOPO devices can be configured via the TOPO.app, which is available for iOS and Android operating systems. RTB has updated the former DD.web 4.0 platform so that users can manage the app with it according to their needs. Because the devices have the 4G/LTE standard, data retrieval is possible in real time.





TRADE FAIRS IN 2022

Visit us at:

March 8-10

IT Trans, Karlsruhe

March 13-18

Light + Building, Frankfurt

March 29-April 1

Intertraffic, Amsterdam

May 18-20

Sight City, Frankfurt

SMALL SNAILS HAVE A BIG IMPACT

Slow "snails" sometimes cause trouble in daily road traffic. With suicidal intent, the small animal can even cause traffic light systems to fail. Due to the weather, 2021 was apparently a real snail year. Some snails were out to conquer the con-

trol devices in traffic light systems. The moisture from the animals caused some circuit boards to short circuit, resulting in equipment failure. The culprits could not be brought to justice, however, as they did not survive the trip.

Merry Christmas

Driven by digitalization, this pandemic year ended better than fine for our industry. It's amazing how well everything still works. With the right amount of discipline and thoughtful care, even strange times like these can be managed.

We wish you and your families good health and every success for the new year.



RTB

PRINTING

Machrádt Graphischer Betrieb KG, Bad Lippspringe

EDITING

HACK PR- und Werbeagentur GmbH, Paderborn

LAYOUT

Melanie Greguol, RTB GmbH & Co. KG, Bad Lippspringe

PUBLISHER

RTB GmbH & Co. KG

Managing Director Rudolf Broer, Matthias Rieger

Schulze-Delitzsch-Weg 10, 33175 Bad Lippspringe

Phone: +49 5252 9706-0; Fax: +49 5252 9706-10

ampel-nachrichten@rtb-bl.de | www.rtbafetraffic.com